

2013 Best Practices Forum on Dropout Prevention

*Connecting in a High Speed World:
Preparing for Graduation and
Beyond*



*April 14-17, 2013
Kansas City, Missouri*



National
Dropout Prevention
Center/Network

On behalf of the National Dropout Prevention Center/Network
and our partners, we welcome you to the
2013 Best Practices Forum on Dropout Prevention



KANSAS CONSORTIUM FOR YOUTH VOICE





April 14, 2013

Dear Forum Participant:

Welcome to beautiful Kansas City, Missouri, location of the **2013 Best Practices Forum on Dropout Prevention** titled *Connecting in a High Speed World: Preparing for Graduation and Beyond*. We are pleased that you have chosen to spend the next few days with us to learn the latest strategies, programs, and information from national experts on the subject of preparing students for graduation and beyond. The planning team has worked diligently to put together a program that offers a wealth of information and many opportunities for you to learn and grow and network. We trust the Forum will prove to be a valuable professional learning experience, one that will be of immediate value and positively impact your ability to support and engage all students and boost our graduation rates. More than 50 sessions have been planned to allow you to learn how to better work with youth in at-risk situations.

We are very appreciative of our partners for this year's Forum. They have provided insight and effort in the planning and securing of many of our speakers and presenters. Our partners for the Forum this year include Camp Fire USA, Communities In Schools of Nebraska, Communities In Schools of Kansas, CVS Caremark, Iowa Department of Education, Kansas City, Kansas Public Schools, Kansas Consortium for Youth Voice, Kansas Enrichment Network, Kansas State Department of Education, Kansas State University, Missouri AfterSchool Network, Missouri Department of Education, Nebraska Child and Families Foundation, and the University of Kansas. We are also grateful to our conference sponsors and to our exhibitors. We trust you will take time to meet them and learn about the products that they represent.

On behalf of the National Dropout Prevention Center/Network and the Forum partners, thank you for participating in this event. We encourage you to visit our Web site: www.dropoutprevention.org for a listing of future professional learning opportunities as well as the benefits of becoming a member of the National Dropout Prevention Network. May the next few days inspire you and validate your work so that you return home with a renewed sense of purpose to America's youth, especially those in at-risk situations.

Sincerely,

A handwritten signature in black ink that reads "Beth P. Reynolds".

Beth P. Reynolds, Ph.D.
Executive Director



NATIONAL DROPOUT PREVENTION CENTER

209 Martin Street Clemson, SC 29631-1555

864.656.2599 FAX 864.656.0136 ndpc@clemson.edu

April 2013

Dear Conference Participants:

Welcome to the 2013 Best Practices Forum on Dropout Prevention, “Connecting in a High Speed World: Preparing for Graduation and Beyond”. We are excited that you are able to join in this celebration of the many accomplishments in the field of dropout prevention.

This year’s keynote speakers include: Ms. Karen Pittman, the founder and CEO of the Forum for Youth Investment which promotes youth development; Ms. Jodi Grant, Executive Director of the Afterschool Alliance which ensures that all children have access to afterschool programs; and Dr. Pellom McDaniels, Assistant Professor of Emory University. He specializes in African American history.

This is a time to engage and connect with other folks in the field of dropout prevention, to learn of their accomplishments and to grow as an educator. We are truly grateful to each of you and are inspired by your incredible dedication.

Thank you and have a great forum!

Sincerely,



Chris L. Nicastro
Commissioner of Education

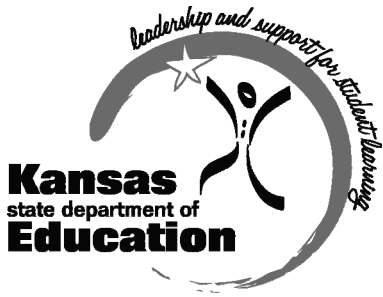

Office of the Commissioner

785-296-3202
785-291-3791 (fax)

120 SE 10th Avenue • Topeka, KS 66612-1182 • www.ksde.org

April 14, 2013

Dear Forum Participants:

It is with pleasure that we welcome you to the 2013 Best Practices Forum on Dropout Prevention. We believe that the Forum will elevate this issue and generate workable solutions to keep our students in school. This year's theme, *Connecting in a High Speed World: Preparing for Graduation and Beyond*, supports the mission of the Kansas State Department of Education to prepare Kansas students for lifelong success through rigorous academic instruction, 21st century career training, and character development according to each student's gifts and talents.

Kansas is pleased to share that every subgroup in the state has increased its graduation rate for the last three years. Additionally, a report from the U.S. Department of Education ranked Kansas 12th in the nation for graduating students from high school. We attribute this success to local efforts that ensure instruction is both engaging to students and relevant. Statewide efforts, such as our move to college and career ready standards and the Career and Technical Education bill passed during the 2012 legislative session, help support those efforts, but it is through the dedication and effort of our local schools that the real progress is being made.

The 2013 Best Practices Forum is designed to provide tools to identify students who are at risk of dropping out as well as successful prevention, intervention and recovery strategies. We believe these resources will enhance your capacity to keep students in school and help them graduate prepared for life.

On behalf of the Kansas State Department of Education, we thank you for your efforts to help students succeed in school and beyond. Together we can make a difference in our children's lives by addressing this crisis head-on and ensuring every student graduates.

Sincerely,

Dr. Diane M. DeBacker
Kansas Commissioner of Education



STATE OF IOWA

TERRY BRANSTAD, GOVERNOR
KIM REYNOLDS, LT. GOVERNOR

DEPARTMENT OF EDUCATION
JASON E. GLASS, DIRECTOR

April 14, 2013

Dear Conference Participants,

It is my pleasure to welcome you to the 2013 Best Practices Forum on Dropout Prevention. This year's theme, *Connecting in a High Speed World: Preparing for Graduation and Beyond*, supports the Iowa Department of Education's commitment to ensure that all students graduate from high school prepared to go to college or to enter the workforce. We applaud teachers, school districts, administrators, and communities for doing whatever it takes to help struggling students finish high school prepared for success in the 21st Century.

Iowa's graduation rates are among the best in the nation. This is a testament to the hard work and commitment that Iowa teachers and school leaders demonstrate every day. While we are proud of this accomplishment, we strive to continue to improve in our state's efforts to become a world-class education system. The 2013 Best Practices Forum on Dropout Prevention is a tremendous resource that provides evidence-based dropout prevention strategies and information to equip our educators and community in their efforts to engage and prepare every student for graduation and beyond.

On behalf of the Iowa Department of Education, I am humbled and inspired by your work to ensure that all students graduate college and career ready.

Sincerely,

A handwritten signature in black ink that reads "Jason E. Glass". The signature is written in a cursive style with a large, prominent "J" and "G".

Jason E. Glass
State Director & Chief Learner
Iowa Department of Education

Grimes State Office Building - 400 E 14th St - Des Moines IA 50319-0146

PHONE (515) 281-5294 FAX (515) 242-5988

www.educateiowa.gov

Championing Excellence for all Iowa Students through Leadership and Service

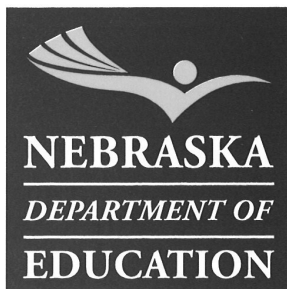

Roger D. Breed, Ed.D., Commissioner
Scott Swisher, Ed.D., Deputy Commissioner

301 Centennial Mall South Tel: (402) 471-2295
PO Box 94987 Fax: (402) 471-0117
Lincoln, NE 68509-4987 Web: www.education.ne.gov

March 29, 2013

Forum Participants:

Welcome to the 2013 Midwestern Best Practices Forum on Dropout Prevention. I believe that regional discussions provide meaningful opportunities for educators and community partners to collaborate as neighbors and to share experiences and best practices concerning some of the best drop-out prevention work in the nation.

I can make that bold statement because a recent report from the U.S. Department of Education ranked Nebraska third in the nation for graduating students from high school. We attribute this success to local Nebraska school district efforts to ensure instruction is both engaging and relevant. We also attribute it to a Midwestern ethic that values the potential of every individual and our sense of collective responsibility.

The conference theme, *Connecting in a High Speed World: Preparing for Graduation and Beyond*, supports the Nebraska Department of Education's mission, which is to prepare all our students for learning, earning and living. We also value excellence through continuous improvement and applaud your efforts to develop and adapt proven strategies that meet the needs of our hardest to reach students so that all our youth have the opportunities they need to gain the social, technical and practical skills that an increasingly complex, high speed world requires.

This Forum is designed to provide you with tools you can use to engage students who are at risk of dropping out as well as successful prevention, intervention and recovery strategies. The conference has a strong strand emphasizing the value of school - community partnerships, especially partnership that expand learning opportunities for at risk youth. While we are very proud of our schools in Nebraska, we understand that we cannot expect schools to meet all of the complex challenges facing youth today on their own. Partnerships are vital and we believe the topics covered in this conference will enhance your capacity to form partnerships and connections needed to keep students in school and help them graduate prepared for the challenges that will confront them in the world beyond our school doors.

On behalf of the Nebraska Department of Education, we thank you for your efforts to help students succeed in school. Together we can give all of our youth, especially those from our most challenging educational environments, the best education for all ... for life.

Sincerely,

A handwritten signature in cursive script that reads "Roger D. Breed".

Roger D. Breed, Ed.D.
Commissioner of Education

To lead and support the preparation of all Nebraskans for learning, earning, and living.

2013 FORUM INFORMATION

For a listing of all FORUM events, arranged by starting time, see the Forum at a Glance on page 1. All sessions will begin promptly, so make every effort to be on time! The program listing includes the meeting location, topic, speakers, and a description of the session.

The formats for all FORUM sessions are as follows:

Pre-FORUM Workshops—Participants must preregister and prepay for Pre-FORUM workshops.

Concurrent Sessions—Participants may choose one topic each session.

Carousel Session—Participants may choose two table topics.

2013 FORUM PLANNING COMMITTEE

We offer a special thank you to the following people who served on the 2013 Best Practices Forum on Dropout Prevention Planning Committee:

CVS Caremark

Nancy Volpe

Camp Fire

Tara Markley

Communities In Schools Kansas

Malissa Martin

Communities In Schools Nebraska

Shelley Henderson

Free State High School

Dante Colombo

Teanna Totten

Iowa Department of Education

Barb Anderson

Cyndy Erickson

Susan Walkup

Kansas City, Kansas Public Schools

Tyrone Bates, Jr.

Lisa Garcia

Kansas Enrichment Network

Claudia Conner

Marcia Dvorak

Kevyn Gero

Kansas State Department of Education

Nicolette Geisler

Chris Macy

Cherie Nicholson

Jessica Noble

Kansas State University

Elaine Johannes

Missouri AfterSchool Network

Terri Foulkes

Danielle Turley

National Dropout Prevention Center/Network

Sandy Addis

Peg Chrestman

John Gailer

Denise Gianforcaro

Debbie Hall

Emily Meeks

John Peters

Lea Pisteolis

Beth P. Reynolds

Nebraska Children and Families Foundation

Jeff Cole

University of Kansas

Michael Crawford

Rebecca Gillam

Nadia Jessop

FORUM AT A GLANCE

Date and Time	Event	Page
<u>Sunday, April 14, 2013</u>		
12:00 noon - 5:00 p.m.	Registration	2
1:00 p.m. - 4:00 p.m.	Pre-FORUM Workshops (<i>Must be preregistered.</i>)	
	PFW1. <i>From High Chairs to Higher Education</i>	2
	PFW2. <i>Endless Dreams: Building Educational Support for Youth in Foster Care</i>	2
	PFW3. <i>Tell Your Story Well: Linking Data to the Human Story of Dropout Prevention</i>	2
2:15 p.m. - 2:30 p.m.	Refreshment Break	2
<u>Monday, April 15, 2013</u>		
8:00 a.m. - 9:00 a.m.	Continental Breakfast	3
8:00 a.m. - 5:00 p.m.	Exhibit Hall Open/Registration	3
9:00 a.m. - 11:15 a.m.	Opening General Session <i>Plenary Speaker: Mr. David A. Smith</i> <i>Keynoter: Ms. Karen Pittman</i>	3
11:30 a.m. - 12:45 p.m.	Boxed Lunch	3
1:00 p.m. - 2:00 p.m.	Concurrent Sessions	4
1:00 p.m. - 2:00 p.m.	Carousel Session	5
2:00 p.m. - 2:15 p.m.	Transition/Break	6
2:15 p.m. - 3:15 p.m.	Concurrent Sessions	6
3:30 p.m. - 4:30 p.m.	Concurrent Sessions	7
4:30 p.m. - 6:00 p.m.	Forum Reception	8
<u>Tuesday, April 16, 2013</u>		
7:30 a.m. - 8:30 a.m.	Continental Breakfast	10
7:30 a.m. - 4:00 p.m.	Exhibit Hall Open	10
7:30 a.m. - 4:00 p.m.	Registration	10
8:30 a.m. - 9:45 a.m.	General Session <i>Keynoter: Ms. Jodi Grant</i>	10
9:45 a.m. - 10:00 a.m.	Transition/Break	10
10:00 a.m. - 11:30 a.m.	Concurrent Sessions	10
11:30 a.m. - 1:00 p.m.	Deli Buffet/Networking Luncheon	11
1:00 p.m. - 2:30 p.m.	Concurrent Sessions	11
2:30 p.m. - 2:45 p.m.	Transition/Break	12
2:45 p.m. - 4:15 p.m.	Concurrent Sessions	12
<u>Wednesday, April 17, 2013</u>		
7:30 a.m. - 8:30 a.m.	Coffee Service	14
7:30 a.m. - 12:15 p.m.	Registration	14
8:30 a.m. - 9:30 a.m.	Concurrent Sessions	14
9:45 a.m. - 10:45 a.m.	Concurrent Sessions	14
10:45 a.m. - 12:15 p.m.	Closing Session/Brunch <i>Keynoter: Dr. Pellom McDaniels</i>	15
Directory of Presenters		16
Directory of Exhibitors		19

2013 Best Practices Forum on Dropout Prevention Keynote Speakers



Monday, April 15, 2013, 9:45 a.m.

Karen Pittman

Founder and CEO, Forum for Youth Investment

“Broadening the Goal: From Graduation to Readiness”

Karen has made a career of starting organizations and initiatives that promote youth development—including the Forum for Youth Investment, which she co-founded with Merita Irby in 1998. In 1990 she became a vice president at the Academy for Educational Development, where she founded and directed the Center for Youth Development and Policy Research and its spin-off, the National Training Institute for Community Youth Work. In 1995 Karen joined the Clinton administration as director of the President's Crime Prevention Council. From there she moved to the executive team of the International Youth Foundation (IYF). Karen has written three books, served on numerous boards and panels, and is a respected public speaker. She currently sits on the America's Promise Board of Trustees; YouthBuild USA; and the U.S. Census Bureau's National Advisory Committee on Racial, Ethnic and Other Populations.



Tuesday, April 16, 2013, 8:30 a.m.

Jodi Grant

Executive Director, Afterschool Alliance

“The Road to Graduation: How and Why Quality Afterschool Programs are Instrumental”

Since 2005, Jodi Grant has been Executive Director of the Afterschool Alliance, a nonprofit public awareness and advocacy organization working to ensure that all children and youth have access to quality, affordable afterschool programs. Prior to joining the AfterSchool Alliance, Grant served as Director of Work and Family Programs for the National Partnership for Women & Families. Prior to that, she worked on Capitol Hill as General Counsel to the Senate Budget Committee and as Staff Director for a Senate Committee. She also served as liaison to the National Governors' Association, where she worked closely with Republican and Democratic governors. She currently serves as a Trustee of the America's Promise Alliance, an Advisory Board Member of Time Warner Cable's "Connect a Million Minds" campaign, and as Co-Chair of the Chicago Museum of Science and Industry's Student Development Advisory Committee.



Wednesday, April 17, 2013, 10:45 a.m.

Pellom McDaniels

Assistant Professor, Emory University; Former NFL Player

“Becoming Exceptional: Assisting Student Desires for Knowledge and Education in an Anti-Intellectual Environment”

Dr. McDaniels is the Faculty Curator of African American Collections and Assistant Professor of African American Studies at Emory University. Specializing in African American history, biography, sports, and masculinities studies, Dr. McDaniels has co-curated a number of exhibitions. He has published numerous works related to African American culture and history. Dr. McDaniels' community outreach work includes 20 years of service to the greater Kansas City community. As a member of the Kansas City Chiefs football team from 1992-1998, he made himself a part of the community working to change the misperception of African American athletes as anything but intellectual. His community work began as response to the reduction of support for the arts, which he found appallingly absent in elementary schools. He has also served as the chairman of the Negro Leagues Baseball Museum's Board of Directors; a Trustee of the National World War I Museum; and a board member of the Black Archives of Mid America in Kansas City.

12:00 noon - 5:00 p.m.

REGISTRATION

Location: Ballroom Foyer

PRE-FORUM WORKSHOPS

(Must be preregistered.)

1:00 p.m. - 4:00 p.m.

PFW1. FROM HIGH CHAIRS TO HIGHER EDUCATION

Location: Pavilion 1

Presenters: Ms. Lisa Garcia, Mr. Tyrone Bates, Jr., and Mr. Jarius Jones, Kansas City, Kansas Public Schools, Kansas City, KS

This presentation will provide a snapshot of the programs and practices that have contributed to the success Kansas City, Kansas Public Schools has seen over the last ten years at increasing urban student achievement, the graduation rate, as well as being named one of the nation's top 100 communities in America. We hope that each workshop attendee will leave with ideas that they can fashion to meet similar needs in their context.

PFW2. ENDLESS DREAMS: BUILDING EDUCATIONAL SUPPORT FOR YOUTH IN FOSTER CARE

Location: Pavilion 2

Presenter: Ms. Cassy Rockwell, Nebraska Children and Families Foundation, Lincoln, NE

Endless Dreams provides educators with information needed to support the academic success of youth in foster care. This interactive session is presented by the Nebraska Children and Families Foundation: a group of young adults with foster care experience whose mission is to use their voice and experience to improve the foster care system for those that follow them.

PFW3. TELL YOUR STORY WELL: LINKING DATA TO THE HUMAN STORY OF DROPOUT PREVENTION

Location: Pavilion 3

Presenter: Ms. Jean Synodinos, Health Communications Specialist, Austin, TX

We may all be familiar with the compelling data around dropouts, but numbers alone cannot tell the full story behind our efforts to prevent it. By learning to link data to the larger, human story of dropout prevention—and by learning to present that data in compelling ways—we can tap into discover a potent communication tool for moving audiences to action.

2:15 p.m. - 2:30 p.m.

REFRESHMENT BREAK

Location: Ballroom Foyer

**We are proud to sponsor the
2013 Best Practices Forum
on Dropout Prevention**



**KANSAS
ENRICHMENT
NETWORK**

*Making Connections for
Out-of-School Time*

The Kansas Enrichment Network is dedicated to ensuring that all Kansas children to have access to safe, affordable and high quality afterschool and expanded learning programs. Out of school programs offer an opportunity to engage youth and help them learn, grow, and prepare for the future.

8:00 a.m. - 9:00 a.m.

CONTINENTAL BREAKFAST

Location: Ballroom Foyer

8:00 a.m. - 5:00 p.m.

EXHIBIT HALL OPEN/REGISTRATION

Location: Ballroom Foyer

9:00 a.m. - 11:15 a.m.

(All are invited to attend.)

OPENING GENERAL SESSION

Location: Salon IB - Salon II

WELCOME AND REMARKS

Dr. Sandy Addis, National Dropout Prevention Center/Network, Clemson, SC

Ms. Nancy Volpe, CVS Caremark, Overland Park, KS

INTRODUCTION OF PLENARY SPEAKER

Dr. Doug Christenson, former Nebraska Commissioner of Education, Lincoln, NE

PLENARY SPEAKER

Mr. David A. Smith, Chief of Staff for Kansas City, Kansas Public Schools

Kansas City, Kansas Public Schools has experienced a remarkable turnaround in a diverse student environment that posted a 43.9% graduation rate and a youth poverty level of 36.4%. Through dedication to improving educational outcomes, the District stepped up to unify youth support programs in the community, helping to raise math proficiency from 3% to 68%, and reading from 11% to 67%. New programs, such as First Things First fosters youth development by strengthening relationships between families and schools; the Early Release model enables teachers to improve their skills; and the Link Crew initiative encourages community service and involvement. These replicable innovations garnered the recognition of a 100 Best Communities designation by America's Promise Alliance for 2013. Dr. Lane will share how one community has come together to drastically improve achievement and improve high school graduation rates.

KEYNOTE SPEAKER

Ms. Karen Pittman, Founder and CEO, Forum for Youth Investment, Washington, DC

BROADENING THE GOAL: FROM GRADUATION TO READINESS

A survey of over 400 employers pointed out the difference between these two terms: Employers reported that 4 in 10 applicants for entry level jobs with high school diplomas were grossly unready for work. Colleges report similar if not higher numbers. Too often, young people who have dropped out or are at risk of dropping out have disengaged not just because they are behind academically, but because they do not believe their schools are committed to helping them be ready for college, work, and life and, equally important, do not feel respected, connected or recognized. Pittman will review research and practice examples of the value of embracing this goal shift and invite discussion.

CLOSING REMARKS

Ms. Malissa Martin, Communities In Schools of Kansas, Lawrence, KS

11:30 a.m. - 12:45 p.m.

BOXED LUNCH

NOTE: During the time period of 1:00 p.m. to 2:00 p.m. participants have a choice of formats:

- (1) Choose one Concurrent Session
- OR**
- (2) Choose the Carousel Session and attend two roundtable discussions.

CONCURRENT SESSIONS

(Participants choose one.)

1:00 p.m. - 2:00 p.m.

THREE CASE STUDIES OF STUDENTS' INVOLVEMENT IN A DROPOUT PREVENTION INTERVENTION

Strand: Preventing and Recovering Dropouts
Location: Salon 1A
Presenters: Dr. Jennifer Schnakenberg and Dr. Meghan Coleman, Meadows Center for Preventing Educational Risk, Austin, TX

This session provides case studies of three students involved in a dropout prevention intervention implemented within a larger, IES-funded study. Daily and weekly implemented interventions will be discussed along with the students' self-reported outcomes related to engagement, connections to school, and relationships with their dropout prevention advisors.

ATTENTION AND PERCEPTION: THE NUTS AND BOLTS OF LEARNING

Strand: Instructing Students
Location: Salon 3
Presenter: Dr. Jean Strait, Hamline University's Center for Excellence in Urban Teaching, St. Paul, MN

Some scientists argue that attention can equate to consciousness, while others regard them as different levels of the same brain function. It does matter if/that your students pay attention. Come and learn how you can hook the students and keep them hooked throughout a lesson.

USING EXTRACURRICULAR ACTIVITIES TO MOTIVATE YOUR STUDENTS TO GRADUATION AND BEYOND

Strand: Engaging Students
Location: Pavilion 1
Presenter: Mrs. Tammie Pate, Hamline University, St. Paul, MN

This session discusses utilizing best practices to motivate students to graduation through extracurricular activities. Participants will discuss various student engagement methods that have proven successful in motivating students to graduation and beyond.

TOOLS TO PREVENT THE DISSOLUTION OF A DROPOUT! BEST PRACTICES TO LINK SCHOOLS, FAMILIES, AND COMMUNITIES

Strand: Engaging Family and the Community
Location: Pavilion 2
Presenters: Dr. Edwin Javius and Ms. Karina Lugo-Villalba, Educational Empowerment, San Jose, CA

The attendees will learn five best practices for engaging families and communities: 1) parent-school navigation, 2) financial and reading literacy, 3) teen-mom dropout, 4) home visitations, and 5) parent leadership council. Educational Empowerment, a community-based organization, will provide clear actions to implement the dropout best practices.

OUT OF THE SHADOWS: HOW A GRASSROOTS PROGRAM SUPPORTED RELATIONSHIPS, RETENTION, AND MOTIVATION OF MARGINALIZED STUDENTS IN A RURAL HIGH SCHOOL

Strand: Preventing and Recovering Dropouts
Location: Pavilion 3
Presenter: Ms. Heather Batchelor, Westminster College, Salt Lake City, UT

This presentation examines the impact of a program developed in a high poverty rural high school that utilized service-learning, goal setting, mentoring, and community building to address the needs of marginalized students. Students involved demonstrated marked improvements in indicators for dropping out of school.

INDIVIDUALIZED, INNOVATIVE, AND INSPIRATIONAL: REINVENTING HIGH SCHOOL FOR STRUGGLERS AND STRIVERS THROUGH BLENDED LEARNING

Strand: Preparing for College and Career
Location: Suite 141
Presenters: Ms. Mickey Revenaugh and Ms. Dawna Thornton, Connections Learning, Baltimore, MD; and Ms. Laura Segala, Connections Learning, Plymouth, MN

Come learn about a new breed of research-based "blended learning" high schools that combine cool technology, sophisticated data, new staff roles, and radically reinvented physical spaces to provide a transformational school experience that gives every student a head start on success in college and career.

CAROUSEL SESSION

(Participants choose two.)

1:00 p.m. - 2:00 p.m.

Location: Salon IB - Salon II

The room will be arranged in roundtables (seating eight/table) with a number and presentation title posted at each table. Each participant will choose a table and be seated; the carousels will then begin. During the remaining time, each carousel presenter will make two 30-minute presentations.

LITERACY, DROPOUT FACTORIES, AND THE ECONOMY: THE IMPACT OF ADOLESCENT LITERACY INSTRUCTION ON GRADUATION RATES AND ECONOMIC DEVELOPMENT

Strand: Preventing and Recovering Dropouts

Location: Table 1

Presenter: Dr. Carolyn Carlson, Washburn University, Topeka, KS

One in ten high schools is considered a “dropout factory,” resulting in almost 7,000 dropouts each day due mainly to poor literacy skills preventing students from keeping up with the curriculum—a result of the lack of literacy instruction. This has a significant economic impact—not only in less income, but also in money spent remediating the literacy skills when they enter the workforce. This session examines the need for a stronger focus on adolescent literacy, the lack of secondary reading specialists, and the impact on the economy.

EDUCATIONAL OUTCOMES FOR YOUTH IN FOSTER CARE

Strand: Preventing and Recovering Dropouts

Location: Table 2

Presenter: Ms. Betsy Thompson, The University of Kansas, Lawrence, KS

The Kansas Partnership on Educating Kids in Care is a cross systems partnership to build child welfare–education system collaboration to improve educational outcomes for youth in foster care. I will describe the project, share insights on data sharing across systems, and connect the work to dropout and truancy prevention.

THAT’S A WRAP: TRUANCY PREVENTION

Strand: Preventing Truancy and Improving Attendance

Location: Table 3

Presenters: Ms. Marilu Flores and Ms. Amanda Croft, AAMA - Sanchez Charter School, Houston, TX

Current systems making a significant impact at an urban charter school for at-risk students will be presented. Truancy officers and wraparound services work in unison, capitalize on daily communication, providing outreach to students and parents. The importance of tracking systems, wraparound services, accountability, and individualized student interactions will be presented.

CONFUSED TO COMMITTED: ENGAGING STUDENTS THROUGH GRADUATION AND BEYOND

Strand: Engaging Students

Location: Table 4

Presenter: Ms. Julie Carriere, Simon Youth Foundation, Indianapolis, IN

Simon Youth Foundation has established joint ventures with public school districts in 13 states, resulting in over a 90% graduation rate of more than 10,000 graduates in 15 years. Through partnerships with other national partners, students receive job and life skills training, encouragement, and support to succeed. In this presentation, attendees will learn how creating an environment that is centered around individual learning empowers the student to obtain a high school diploma and gain entry into postsecondary institutions or the workplace.

LEARNING COLLABORATIVELY IN A HOME-BASED SUMMER YOUTH READING PROGRAM

Strand: Engaging Family and the Community

Location: Table 5

Presenters: Mrs. Lynn Turner, Florida State University, Tallahassee, FL; and Ms. Tomica Smith, Palmer-Munroe Teen Center, Tallahassee, FL

In this session a successful Summer Youth Reading Program will be described verbally and in pictures. The program’s uniqueness is that it is facilitated in a home where groups of adolescent males eagerly participate with their peers. This program promotes parental and community involvement and engages youth in interactive learning.

1:00 p.m. - 2:00 p.m.

**THE INTERRELATIONSHIP BETWEEN
KNOWLEDGE BASE, SELF-EFFICACY, AND
SELF-CONFIDENCE IN TESOL TEACHER
EDUCATION: A RESEARCH-BASED MODEL**

Strand: Applying Quality Data
Location: Table 6
Presenters: Dr. Nancy Albrecht and Dr. Salim Sehlaoui,
Emporia State University, Emporia, KS

This session will present a poster outlining a research study that explored ESU teacher education graduates' self-efficacy and self-image as it relates to content knowledge areas such as assessment, applied linguistics, and cross-cultural communication. This research is relevant to those teaching Linguistically and Culturally Diverse (LCD) students, especially English Learners (ELs). Participants will explore this research study and come away with an understanding of which content knowledge areas make teachers most effective with LCD students.

2:00 p.m. - 2:15 p.m.

TRANSITION/BREAK

Location: Ballroom Foyer

CONCURRENT SESSIONS

(Participants choose one.)

2:15 p.m. - 3:15 p.m.

CULTURAL COMPETENCY WORKSHOP

Strand: Shaping School Climate
Location: Salon 1A
Presenter: Dr. Jean Strait, Hamline University's Center for
Excellence in Urban Teaching, St. Paul, MN

Culture is the ideals, beliefs, skills, tools, customs, and institutions into which each member of society is born. How can educators use instructional strategies to enhance learning environments and create a safe space for learning? Come and try out different scenarios in this practice.

**BUILDING RESILIENCE TO IMPROVE
PERFORMANCE AND ACADEMIC
ENGAGEMENT**

Strand: Engaging Students
Location: Salon 3
Presenter: Ms. Melissa Schlinger, ScholarCentric,
Denver, CO

Students disengage for a variety of reasons. During this presentation we will examine the six resiliency skills that are critical to students staying engaged and performing at their highest academic potential. We will also discuss how to incorporate research-based intervention strategies to teach resiliency to middle and high school students.



Nebraska Children

AND FAMILIES FOUNDATION

Creating positive change for children
through community engagement.

“13,000 AND COUNTING”—FROM HIGH SCHOOL TO COLLEGE AND CAREER

Strand: Preparing for College and Career
 Location: Pavilion 1
 Presenters: Mr. Michael Carter, Mr. Chris Welch, Ms. Kates Brommeland, and Mr. Michael Gaines, Sinclair Community College, Dayton, OH

Sinclair Community College has partnered and collaborated with the local community to create almost 20 programs serving 13,000 pre-college students. These programs engage youth that are dropouts, at risk, career tech, and college ready, as well as low income and underserved. Sinclair also has a system in place to support those students who transition to Sinclair upon high school graduation.

IMMEDIATE INTERVENTIONS FOR AT-RISK STUDENTS

Strand: Preventing and Recovering Dropouts
 Location: Pavilion 2
 Presenters: Mrs. Deborah O’Brien and Dr. Rebekah Richards, NoDropouts, Salt Lake City, UT

This presentation will discuss the NoDropouts tiered intervention program, which monitors student achievement against past work and clearly communicated expectations, helping academic coaches keep students on pace for graduation.

THE A.B.L.E. SYSTEM FOR GROWTH AND ACHIEVEMENT™

Strand: Engaging Students
 Location: Pavilion 3
 Presenters: Mr. John Theis, Mrs. Deb Theis, and Mr. Terry George, Nickerson Elementary School, Nickerson, KS

The A.B.L.E. System is a comprehensive program which targets the daunting problems associated with low levels of student hope, engagement, and well-being. The program utilizes the use of proprietary reflection instruments for all stakeholders to aid them in understanding how their own attitude, behavior, learning, and effort (A.B.L.E.) impacts student growth and achievement. A.B.L.E. can also be used to support MTSS, antibullying, and serves as the socio-emotional/motivational underpinning for college and career readiness.

WHAT DOES ADOLESCENT BRAIN RESEARCH REALLY MEAN FOR YOUTH PRACTITIONER BEST PRACTICE? YOU MIGHT BE SURPRISED

Strand: Positively Developing Youth
 Location: Suite 141
 Presenters: Mr. Michael Crawford, University of Kansas, Lawrence, KS; and Dr. David Hansen, Department of Psychology and Research in Education, Lawrence, KS

How should adolescent brain research change what we do? This session will cover the applied meaning of brain changes during adolescence—what these changes mean for best practices with youth and youth programs—and dispel the myth that the adolescent brain is “immature” (not adult) until the late twenties.

CONCURRENT SESSIONS

(Participants choose one.)

3:30 p.m. - 4:30 p.m.

ENGAGING ADOLESCENTS IN ACADEMIC LEARNING: ROLE OF TUTORS AND COMMUNITY-BASED AFTER-SCHOOL SETTINGS

Strand: Engaging Students
 Location: Salon 1A
 Presenters: Mrs. Lynn Turner, Florida State University, Tallahassee, FL; and Ms. Tomica Smith, Palmer-Munroe Teen Center, Tallahassee, FL

Findings from a study on math tutoring of adolescent Black males in nonacademic settings indicate the importance of autonomy-support, academic self-regulation, positive socialization, and the tutor’s role. Key characteristics of effective tutors and features of the setting will be discussed by the researcher and a successful teen center administrator.

EMPOWERING ALL STUDENTS TO SUCCEED IN AN EVER-CHANGING WORLD

Strand: Preventing and Recovering Dropouts
 Location: Salon 3
 Presenter: Mr. Troy Terronez, Watertown High School, Watertown, SD

Is your school experiencing a larger than desired dropout rate? Do you want to improve the achievement gap you see in your school? We will discuss the logistics in bringing a successful alternative program right into our rural South Dakota high school, as well as implementation of philosophies and programming designed to reach the at-risk learner.

3:30 p.m. - 4:30 p.m.

WHAT DOES IT TAKE FOR YOUTH TO REACH THEIR FULL POTENTIAL, TO THRIVE?

Strand: Positively Developing Youth
Location: Pavilion 1
Presenters: Mr. Michael Lemon and Mr. James Martinson, Camp Fire National Headquarters, Kansas City, MO; and Ms. Rebecca Gillam, The University of Kansas, Lawrence, KS

Join us if you are interested in learning more about the cutting-edge, research-based techniques coming out of the Thrive Foundation for Youth. Camp Fire is one of the first national youth-serving organizations to implement and scale-up the Step-It-Up-2-Thrive Initiative across its entire system. This presentation will explain the four parts of the Thrive Theory of Change and how it is being integrated into Camp Fire.

CVS CAREMARK: WORKFORCE DEVELOPMENT THROUGH COLLABORATION

Strand: Preparing for College and Career
Location: Pavilion 2
Presenter: Ms. Lena Barkley, CVS Caremark, Detroit, MI

CVS Caremark, a cutting-edge leader in workforce development, understands that investment in the well-being and education of youth improves lives and builds communities—affecting the corporate bottom line. Through the innovative Pathways to Pharmacy internship program aimed at inner-city, rural, and disadvantaged high school students, CVS Caremark has established community partnerships with all sectors. Learn from CVS Caremark about how their Workforce Initiatives team, in collaboration with United Ways, community colleges, schools of pharmacy, universities, workforce investment boards, health professionals, and the Department of Labor have successfully impacted the futures of hundreds of youth across the country, helping to stem the tide of high school dropouts and offering opportunity for postsecondary and college completion.

SUCCESSION PLANNING: WHO HAS TIME FOR THAT?

Strand: Preventing and Recovering Dropouts
Location: Pavilion 3
Presenter: Ms. Judy Frick, Communities In Schools of Kansas, Wichita, KS

The purpose of this workshop is to introduce participants to succession planning, the succession basics, and the Executive Transition Management (ETM) process, which can be implemented for any transition. Participants will also assess their succession readiness and learn about the Leadership Transition/Succession Planning Toolkit created as part of the Baldwin Fellowship for CIS National.

MINNESOTA'S EARLY INDICATOR AND RESPONSE SYSTEM

Strand: Preventing and Recovering Dropouts
Location: Suite 141
Presenters: Dr. Cammy Lehr and Ms. Angie Johnson, Minnesota Department of Education, Roseville, MN

The Minnesota Department of Education conducted a study to validate indicators that could be used to identify students who may need additional assistance to graduate from high school in four years. Participants will learn how this information will be used to assist educators to screen and provide supports at multiple levels for students who are off track to graduation in grades 6 and 9.

4:30 p.m. - 6:00 p.m.

FORUM RECEPTION

Location: Ballroom Foyer and Salon IB - Salon II

Join fellow Forum participants and Exhibitors in this networking opportunity and enjoy a sample of Kansas City cuisine.



To learn more, visit us at www.cvscaremark.com/community



There's a lot of talk about diversity these days. And while talk is great, we don't stop there—because diversity of ideas, viewpoints and our work force is an important part of the daily fabric at CVS Caremark. It makes us stronger and better able to serve the world in which we live. That's why we're committed to fostering a culture of respect and openness through inclusion.

You see, we found that all differences make a great difference in building relationships that improve the quality of human life.

Inclusion



7:30 a.m. - 8:30 a.m.

CONTINENTAL BREAKFAST

Location: Ballroom Foyer

7:30 a.m. - 4:00 p.m.

EXHIBIT HALL OPEN

Location: Ballroom Foyer

7:30 a.m. - 4:00 p.m.

REGISTRATION

Location: Ballroom Foyer

GENERAL SESSION

(All are invited to attend.)

8:30 a.m. - 9:45 a.m.

Location: Salon IB - Salon II

WELCOME AND REMARKS

Mr. Jeff Cole, Nebraska Children and Families Foundation, Lincoln, NE

INTRODUCTION OF KEYNOTE SPEAKER

Ms. Elaine Johannes, Kansas State University, Manhattan, KS

THE ROAD TO GRADUATION: HOW AND WHY QUALITY AFTERSCHOOL PROGRAMS ARE INSTRUMENTAL

Keynote: Ms. Jodi Grant, Executive Director, AfterSchool Alliance, Washington, DC

The presentation will focus on how afterschool programs are working with our schools to help students come to school, stay in school and graduate. It will also include research that highlights why afterschool programs are essential to keep students engaged in learning, some of the "hottest topics" in our afterschool programs, and highlight the federal threats and challenges to afterschool programming and funding.

CLOSING REMARKS, ANNOUNCEMENTS

Mr. John Gailer, NDPC/N, Clemson, SC

9:45 a.m. - 10:00 a.m.

TRANSITION BREAK

Location: Ballroom Foyer

CONCURRENT SESSIONS

(Participants choose one.)

10:00 a.m. - 11:30 a.m.

STRATEGIES AND MORE STRATEGIES FOR TEACHING DIVERSE LEARNERS

Strand: Shaping School Climate

Location: Salon 1A

Presenter: Dr. Jean Strait, Hamline University's Center for Excellence in Urban Teaching, St. Paul, MN

Culture is the ideals, beliefs, skills, tools, customs, and institutions into which each member of society is born. How can educators use instructional strategies to enhance learning environments and create a safe space for learning? Come and try out different scenarios in this practice.

ENGAGING FAMILY AND COMMUNITY TO PROTECT CHILDREN FROM DROPPING OUT OF SCHOOL

Strand: Engaging Family and the Community

Location: Salon 3

Presenter: Dr. Willie Kimmons, Save Children Save Schools, Inc., Daytona Beach, FL

High school dropouts are unlikely to have the minimum skills and credentials to function in today's complex society and workplace. Parental discipline, monitoring, encouragement and consistency along with an authoritative parenting style, characterized by warmth and concern coupled with boundaries have been shown to have a positive effect on students.

CREATING A CLIENT-CENTERED, THERAPUTIC SCHOOL CLIMATE FOR AT-RISK STUDENTS

Strand: Shaping School Climate

Location: Pavilion 1

Presenters: Mr. Cornelius Pratt, Mr. Chris Glover, Ms. Tunisha Summers, and Mr. Steve Williams, Nelson C. Nix Educational Center, Orangeburg County School District 5, Orangeburg, SC

Our team will provide participants with highly effective strategies used at Nelson C. Nix to create a safe learning environment for all stakeholders. These include decreasing the dropout rate, increasing the attendance, credit retrieval, accelerated learning, effective behavior management skills, learning strategies, social personal skills training, remediation, and data-driven decision making. Participants will receive an implementation guide as well.

THE TOP TEN THINGS EVERY TEACHER MUST KNOW

Strand: Preventing and Recovering Dropouts
 Location: Pavilion 2
 Presenter: Mr. Hotep, Hustle University, Stone Mountain, GA

A rock 'em-sock 'em presentation for teachers and administrators both new and seasoned! Combining ancient wisdom and best practices from great educators and success coaches around the nation, this workshop sheds light on ten little ideas that make a BIG difference in education. We will dispel common myths regarding: cultural diversity; engaging at-risk youth; modifying behavior; reducing referral; effective class management, using incentives; and the single BIGGEST, transformational secret about education.

IMPLEMENTATION OF EARLY WARNING INTERVENTION AND MONITORING SYSTEMS

Strand: Preventing and Recovering Dropouts
 Location: Pavilion 3
 Presenters: Dr. Mindee O'Cummings and Dr. Susan Therriault, American Institutes for Research, Washington, DC

The National High School Center has devised a seven-step Early Warning Intervention and Monitoring System (EWIMS) implementation process to support the establishment and implementation of early warning systems for identifying and monitoring students who are at risk for dropping out of high school. The process is based on research about data-driven decision making. Presenters will describe the steps to make informed decisions about how to support at-risk students and how to continue to monitor their progress over time.

BUILDING RELATIONSHIPS AND CONNECTIONS

Strand: Positively Developing Youth
 Location: Suite 141
 Presenter: Mrs. Joyce Huff, The Dibble Institute, Kansas City, MO

How often do relationships interfere with our student's lives? This interactive workshop will introduce participants to the activities of an innovative youth development curriculum, "Love Notes." It is a research-based program that offers a fresh approach in relationship violence prevention. This new conceptual framework taps new sources of motivation to prevent pregnancy and dangerous relationships. The activities integrate multiple media and engage youth in news ways to make positive decisions regarding their relationship.

11:30 a.m. - 1:00 p.m.

DELI BUFFET/NETWORKING LUNCHEON

Location: Salon IB - Salon II

CONCURRENT SESSIONS

(Participants choose one.)

1:00 p.m. - 2:30 p.m.

AN INVESTMENT IN THE FUTURE: ENGAGING STUDENTS BY MEETING STUDENT'S NEEDS

Strand: Engaging Students
 Location: Salon 1A
 Presenters: Dr. Judith Pauley and Mr. Joseph Pauley, Process Communications, Inc., Potomac, MD

A seventh grade teacher in an alternative school used the concepts of Process Communications to establish relationships with her students. Thirty of 31 students improved their grades and/or significantly decreased their disruptive behaviors. One boy stopped fighting. Two girls stopped cutting themselves and no longer thought about committing suicide. Participants will learn these concepts.

TEN STRATEGIES PROVEN TO INSPIRE EVEN THE MOST STRUGGLING STUDENT

Strand: Shaping School Climate
 Location: Salon 3
 Presenter: Mr. Christian Moore, The WhyTry Program, Provo, UT

How do you engage the most challenging students? Learn ten strategies that have proven to build relationships, grab attention, and inspire students in K-12 schools, mental health, and correctional organizations worldwide. Learn to speak the language of today's youth using relevant multimedia, physical activities, and visual metaphors.

TIME TO TALK: GOING ABOVE AND BEYOND

Strand: Engaging Students
 Location: Pavilion 1
 Presenters: Ms. Janet Corral and Ms. Sylvia Best, Sunset High School, El Paso, TX

Time to Talk provides students with life-skills management by getting them involved in community activities. It helps build interpersonal relationships between participants nurturing an environment of support for one another in the school setting. This in turn equips students with leadership skills and motivates them to take ownership of their campus, as well as their learning.

1:00 p.m. - 2:30 p.m.

A WALK IN THE PARK: HOW UNIFYING RESOURCES IS IMPROVING PERFORMANCE FOR HIGHLAND PARK HIGH SCHOOL STUDENTS

Strand: Preventing Truancy and Improving Attendance
Location: Pavilion 2
Presenters: Dr. Beryl New, Ms. Teresa Leslie-Canty, and Mr. Frederic Willer, Highland Park High School, Topeka, KS

Students at Highland Park High School in Topeka, Kansas, are high risk, low income, and traditionally minimally challenged. Through the efforts of school social workers, Communities In Schools staff, school leaders, and community mentors, these students are excelling at a high standard. Providing appropriate wraparound services is the key.

MAKING IT WORK

Strand: Preventing and Recovering Dropouts
Location: Pavilion 3
Presenters: Mrs. Deborah O'Brien and Dr. Rebekah Richards, NoDropouts, Salt Lake City, UT

This presentation will discuss how to change curriculum to better accommodate at-risk learners without impacting core objectives. Through innovative leveling, curriculum designers can make learning materials more accessible and intuitive for students with significant educational and social obstacles.

MONEY HABITUDES

Strand: Engaging Students
Location: Suite 141
Presenter: Mrs. Joyce Huff, The Dibble Institute, Kansas City, MO

What's often missing from financial literacy is attention to the "human" side of money. During this session you will find out your habits and about the "Money Habitudes" curriculum which is designed to engage teens into learning more about themselves and how their money personality affects their spending, goal setting, career choices and managing of relationships. It lays a meaningful foundation on which to build financial skills.

HIGH-TECH TOYS OR CAREER MANAGEMENT TOOLS? USING TECHNOLOGY TO GET A GOOD JOB

Strand: Engaging Students
Location: Suite 241
Presenter: Dr. Anna Graf Williams, Learnovation, LLC, Fishers, IN

Today's students are surrounded by technology 24/7. With smart phones, laptops, and tablets in book bags, Internet accessible

TV's at home, and WIFI connections in every corner shop, they're texting, tweeting, and always connecting. So it's time to take advantage of all that technology and teach them how to use it to get what they really want...a good job. We'll take a look at cloud storage, smart phones, tablets, and the latest apps from a systems perspective. See how to use social media, the Internet, and software as a career management tool. Let's teach students how to use all the technology to market themselves, document their skills and abilities, capture and create work samples classified to the skill competencies employers want to see, and connect professionally to current and potential employers with the goal of increasing salary and setting themselves up for promotion.

2:30 p.m. - 2:45 p.m.

TRANSITION/BREAK

Location: Ballroom Foyer

CONCURRENT SESSIONS

(Participants choose one.)

2:45 p.m. - 4:15 p.m.

YOU GOTTA REACH THEM IN ORDER TO TEACH THEM: REDEFINING EDUCATION FOR A NEW GENERATION

Strand: Preventing and Recovering Dropouts
Location: Salon 1A
Presenter: Mr. Hotep, Hustle University, Stone Mountain, GA

Remember your first day as a teacher when you stood in front of your class and all the educational theory you learned in college went right out the window? We all do! That's because we have to reach our students before they allow us to teach them. This presentation focuses on strategies for connecting with today's youth and using relationship building to enhance student performance. Learn how to improve student engagement, resiliency, and behavior by transforming your classroom into a place that students actually WANT to learn. Also featured is an amazing, eye-opening lesson about media, culture, and gender taught by a kindergarten student!

IMPLEMENTATION OF EARLY WARNING INTERVENTION AND MONITORING SYSTEMS

Strand: Preventing and Recovering Dropouts
Location: Salon 3
Presenters: Dr. Mindee O'Cummings and Dr. Susan Therriault, American Institutes for Research, Washington, DC

The National High School Center, through multiple collaborative projects, has provided technical assistance on early

warning system implementation to 67 districts from six states. This session will provide a summary of the best practices on developing staff capacity to collectively use data to inform identification of students at risk and monitor their response to intervention. Also, lessons learned on overcoming challenges and maximizing successes will be shared.

KEEP IT R.A.W.—RELEVANT, AUTHENTIC AND WELL-INFORMED

Strand: Engaging Students
 Location: Pavilion 1
 Presenters: Mr. Saul Paul and Ms. Bianca Neal,
 ReRoute Productions, Austin, TX

Rappers and music artists have successfully engaged youth audiences by being authentic and raw. As a result, they have gained influence in the lives of youth. Attend this workshop and learn how ANYBODY can draw on this technique to engage students in a RELEVANT WAY that produces positive results. Come join us as we become R.A.W.—Relevant, Authentic and Well-Informed.

STANISLAUS MILITARY ACADEMY

Strand: Positively Developing Youth
 Location: Pavilion 2
 Presenters: Mr. Fred Bigler and Mr. Tom Changnon,
 Stanislaus County Office of Education,
 Modesto, CA

The Stanislaus Military Academy is an alternative school under the jurisdiction of the Stanislaus County Office of Education that provides education for youth referred from city school districts when they are unable to adequately provide supervision and education for their at-risk youth within the high school setting. Our academy uses a military setting to supervise students while providing character training and meeting state academic standards. Students are able to earn a high school diploma, learn social skills, and socialization.

ONLINE MATH REMEDIATION PROGRAM WITH DIFFERENTIATED INSTRUCTION AND LIVE TUTORS STRAND: ENGAGING FAMILY AND THE COMMUNITY

Strand: Instructing Students
 Location: Pavilion 3
 Presenter: Mr. Gary Williams, The Learning System,
 Oklahoma City, MO

“Think Through Math” has enrolled over 2 million students in 41 states into a program with unprecedented motivational tools and adaptive high-quality instruction. TTM uniquely integrates online learning with access to live, certified math teachers who personally differentiate instruction when students continue to struggle. TTM solves one of their biggest problems—“providing effective differentiated instruction.”

MINORITY FAMILIES AND COMMUNITIES: CRITICAL KEYS TO THE SOCIAL AND ACADEMIC SUCCESS OF MINORITY CHILDREN

Strand: Engaging Family and the Community
 Location: Suite 141
 Presenter: Dr. Bernard Oliver, University of Florida,
 Gainesville, FL

Research and social development theory have continually suggested that the impact of family and community involvement is critical in the success and development of minority youth, particularly African American and Latino youth. In this session the presenter provides evidence and models for engaging families and communities in the development of minority youth. What does it take? What do successful programs look like?

**Proud sponsors of the
2013 Best Practices Forum
on Dropout Prevention**



The Missouri Afterschool Network builds systems across the state that improve, support, and sustain high quality afterschool programs with the goal that all school age children and youth in Missouri have access to these high quality, sustainable public and private afterschool programs across the state.

7:30 a.m. - 8:30 a.m.

COFFEE SERVICE

Location: Ballroom Foyer

7:30 a.m. - 12:15 p.m.

REGISTRATION

Location: Ballroom Foyer

CONCURRENT SESSIONS

(Participants choose one.)

8:30 a.m. - 9:30 a.m.

CHOOSING CIVILITY

Strand: Engaging Family and the Community
Location: Salon 1A
Presenters: Mr. Fred Bigler and Mr. Tom Changnon,
Stanislaus County Office of Education,
Modesto, CA

Choosing Civility is a countywide community education outreach started by Mr. Changnon, the Superintendent of Stanislaus County Schools, to encourage more civil behavior. The superintendent has secured other social agencies to join this endeavor, such as the sheriff, local police, various school districts, service clubs, and community businesses. The outreach has been a success in making the community more aware of its responsibility to engage communication in a more productive and successful manner.

LIFE'S NOT A GAME, BUT THIS IS A GAME ABOUT LIFE...

Strand: Positively Developing Youth
Location: Salon 3
Presenters: Mr. SaulPaul and Ms. Bianca Neal,
ReRoute Productions, Austin, TX

SaulPaul reveals an app for iPhones, iPads and Droid devices where middle school and high school students challenge their critical thinking in a dynamic and fun environment. Come ready to play the game, learn the quantifiable teaching and learning impact on students and how to effectively implement digital technology in the classroom.

EMPOWERING ALL STUDENTS TO SUCCEED IN AN EVER-CHANGING WORLD

Strand: Preventing and Recovering Dropouts
Location: Pavilion 1
Presenter: Mr. Troy Terronez, Watertown High School,
Watertown, SD

Is your school experiencing a larger than desired dropout rate? Do you want to improve the achievement gap you see in your school? We will discuss the logistics in bringing a successful alternative program right into our rural South Dakota high school, as well as implementation of philosophies and programming designed to reach the at-risk learner.

SOCIAL AWARENESS: HELPING MINORITY YOUTH ALONG THE PATH OF SOCIAL AND ECONOMIC SUCCESS

Strand: Positively Developing Youth
Location: Pavilion 2
Presenter: Dr. Bernard Oliver, University of Florida,
Gainesville, FL

One of the constant challenges for educating minority youth is the impact of social influences on their decision-making and judgement skills. In this session we focus on the impact and role of social awareness on the social and academic success of students in challenged communities and schools. Particular attention will be focused on self and identity development strategies.

CONCURRENT SESSIONS

(Participants choose one.)

9:45 a.m. - 10:45 a.m.

ALTERNATIVE TEACHING MODELS (ATM): USING PERSONAL STYLE AND FLAVOR TO TEACH WITH ATTITUDE

Strand: Instructing Students
Location: Salon 1A
Presenter: Mr. Hotep, Hustle University,
Stone Mountain, GA

The traditional teaching model is simply outdated. Many educators are still using analog teaching styles for children who live in a digital world. It's time to "update" our operating systems! This workshop provides several different teaching models that educators can use to bring life, personality, and authenticity back into the classroom environment. By thinking out of the box, teachers will learn how to transform the climate of their classroom into one that is uniquely their own, bustling with energy, and easily manageable.

CATALYZING OPPORTUNITY: USING THE OPPORTUNITY INDEX

Strand: Applying Quality Data
Location: Pavilion 1
Presenter: Mr. Russell Krumnow, Opportunity Nation, Boston, MA

Opportunity Nation takes a comprehensive approach to measuring access to opportunity through its Opportunity Index, a groundbreaking tool that includes 16 indicators across education, the economy, and community and civic health that are measured at the state and county levels. The Opportunity Index is a powerful community tool, leading to new conversations, commitments, and partnerships around a common goal and agenda.

DARE TO D.R.E.A.M.—DISCOVER THE REALITY OF EDUCATING ALL STUDENTS INCLUDING STUDENTS WHO HAVE DROPPED OUT DUE TO GAPS IN LEARNING AND IN PARTICULAR, READING AND MATH

Strand: Preventing and Recovering Dropouts
Location: Pavilion 2
Presenter: Ms. Nancy Paulus, MindPlay, St. Louis, MO

Educational Products Group works with school districts and organizations to meet the needs of struggling, older students. We offer programs for students that provide adaptive, diagnostic assessment in reading and math. Based on these results, an individual learning plan is created that guides the student. Success is based on mastery. Both programs have been especially effective with older students and adults and data will be shared at these presentations. These programs have been used in correctional institutions, juvenile justice, adult learning and alternative learning centers. This session will provide an overview and data on the rapid success students make with these web-based programs.

CLOSING SESSION/BRUNCH

(All are invited to attend.)

10:45 a.m. - 12:15 p.m.

Location: Salon IB - II

WELCOME AND REMARKS

Ms. Jessica Noble, Kansas State Department of Education, Topeka, KS

INTRODUCTION OF KEYNOTER

Ms. Jessica Noble

BECOMING EXCEPTIONAL: ASSISTING STUDENT DESIRES FOR KNOWLEDGE AND EDUCATION IN AN ANTI-INTELLECTUAL ENVIRONMENT

Keynoter: Dr. Pellom McDaniels, former NFL player, Assistant Professor, Emory University, Atlanta, GA

The pioneering educator, Carter G. Woodson, believed that the ability of individuals to connect to historical figures who looked like them, who were the central actors in historical narratives, contributed to the development of a positive identity formation in the individuals and on the communities in which they lived. Woodson developed programs to emphasize the importance of lessons found throughout history, especially through biography as a way to connect students to the essential qualities of what made people like Frederick Douglass and Marion Anderson successful. In other words, Woodson wanted to demystify what made exceptional people, exceptional. My talk will discuss the basis of Dr. Woodson’s theories surrounding education and the importance of history, as well as provide an example of a project related to biography as a way to transform how students understand their world and the role they can play in making a better future for themselves and their communities.

CLOSING REMARKS

Ms. Jessica Noble

DIRECTORY OF PRESENTERS

A

ALBRECHT, Nancy, Emporia State University, 1200 Commercial Street, Emporia, KS 66801, 620-341-1200

B

BARKLEY, Lena, CVS Caremark, 5901 Conner St., Detroit, MI, 48213, 313-815-4573, LBarkley@cvs.com

BATCHELOR, Heather, Westminster College, 854 E Harrison Ave., Salt Lake City, UT, 84105, 801-832-2484, hbatchelor@westminstercollege.edu

BATES, Tyrone, Kansas City Kansas Public Schools, 2010 N. 59th St, Kansas City, KS, 66104, 913-279-2094, tybates@kckps.org

BEST, Sylvia, Sunset High School, 2851 Grant Ave., El Paso, TX, 79932, 915-587-2630, ssbest@episd.org

BIGLER, Fred, Stanislaus County Office of Education, 1100 H St., Modesto, CA, 95354, 209-238-6602, fbigler@stancoe.org

BROMMELAND, Kates, Sinclair Community College, 444 W. Third St., Room 12-331, Dayton, OH, 45402, 937-512-5226, kates.brommeland@sinclair.edu

C

CARLSON, Carolyn, Washburn University, 1700 SW College Ave., Carnegie Hall 305, Topeka, KS, 66621, 785-670-1474, carolyn.carlson@washburn.edu

CARRIERE, Julie, Simon Youth Foundation, 225 W. Washington St., Indianapolis, IN, 46204, 317-263-7648, jcarriere@simon.com

CARTER, Michael, Sinclair Community College, 444 W. Third St., Room 12-220, Dayton, OH, 45402, 937-512-3883, michael.carter@sinclair.edu

CHANGNON, Tom, Stanislaus Office of Education, 1100 H St., Modesto, CA, 209-238-1700

COLEMAN, Meghan, Meadows Center for Preventing Educational Risk, 1912 Speedway D4900, Austin, TX, 78712, 512-471-2330, meghancoleman@austin.utexas.edu

CORRAL, Janet, Sunset High School, 2851 Grant Ave., El Paso, TX, 79932, 915-587-2630, jcorral@episd.org

CRAWFORD, Michael, University of Kansas, 1122 West Campus Rd., Lawrence, KS, 66044, 785-864-1874, crawfordjmichael@gmail.com

CROFT, Amanda, AAMA - Sanchez Charter School, 6001 Gulf Freeway, Houston, TX, 77023, 713-926-1112, acroft@aama.org

F

FLORES, Marilu, AAMA - Sanchez Charter School, 6001 Gulf Freeway, Houston, TX, 77023, 713-926-1112, meflores@aama.org

FRICK, Judy, Communities In Schools of Kansas, 16 E. Stonebridge Circle, Wichita, KS, 67230, 316-733-4155, jefrick@cox.net

G

GAINES, Michael, Sinclair Community College, 444 W. Third St., Room 12-331, Dayton, OH, 45402, 937-512-3829, michael.gaines5421@sinclair.edu

GARCIA, Lisa, Kansas City Kansas Public Schools, 2010 N. 59th St, Kansas City, KS, 66104, 913-627-4365, lisgarc@kckps.org

GEORGE, Terry, Nickerson Elementary School, 400 N. Nickerson, Nickerson, KS, 67561, 620-422-3215, tgeorge@usd309ks.org

GILLAM, Rebecca, The University of Kansas, 1122 W Campus Rd, Lawrence, KS 66045-3101

GLOVER, Chris, Nelson C. Nix Educational Center, 770 Stilton Rd., Orangeburg, SC, 29223, 803-533-6581, chris.glover@ocsd5.net

GRAF WILLIAMS, Anna, Learnovation, LLC, 10831 Thistle Ridge, Fishers, IN, 46038, 317-577-1190, anna@learnovation.com

GRANT, Jodi, AfterSchool Alliance, 1616 H Street, Ste 820, Washington, DC, 20006, 202-347-2030, info@after-schoolalliance.org

H

HANSEN, David, Dept. of Psychology and Research in Education, 1122 West Campus Rd., Lawrence, KS, 66045-3101, 785-864-1874, dhansen1@ku.edu

HOTEP, Hustle University, 4156 Kings Troop Rd., Stone Mountain, GA, 30083, 404-294-7165, hustleuinc@gmail.com

HUFF, Joyce, The Dibble Institute, 2909 NE 78th St, Kansas City, MO, 64119, 316-640-2450, Joyce@DibbleInstitute.org

I

JAVIUS, Edwin, Educational Empowerment, 2033 Gateway Place, Suite 602, San Jose, CA, 95110, 559-790-1093, javius@edequity.com

JOHNSON, Angie, Minnesota Department of Education, 1500 Hwy. 36 West, Roseville, MN, 55113, 651-582-8845, angie.johnson@state.mn.us

JONES, Jarius, Kansas City Kansas Public Schools, 2010 N. 59th St, Kansas City, KS, 66104, jajones@kckps.org

K

KIMMONS, Willie, Save Children Save Schools, Inc., 1653 Lawrence Circle, Daytona Beach, FL, 32117, 386-451-4780, wjkimmons@aol.com

KRUMNOW, Russell, Opportunity Nation, 112 Water Street, Suite 500, Boston, MA, 02109, 978-502-0910, rkrumnow@opportunitynation.org

L

LEHR, Cammy, Minnesota Department of Education, 1500 Hwy. 36 West, Roseville, MN, 55113, 651-582-8563, cammy.lehr@state.mn.us

DIRECTORY OF PRESENTERS

LEMON, Michael, Camp Fire National Headquarters,
1100 Walnut St, Suite 1900, Kansas City, MO, 64106,
8162852027, michael.lemon@campfire.org

LESLIE-CANTY, Teresa, Highland Park High School,
2424 SE California, Topeka, KS, 66605, 785-274-6035,
tleslie@topeka.k12.ks.us

LUGO-VILLALBA, Karina, Educational Empowerment,
2033 Gateway Place, Suite 602, San Jose, CA, 95110,
408-451-3930, rubeez4@gmail.com

M

MARTINSON, James, Camp Fire National Headquarters,
1100 Walnut St., Suite 1900, Kansas City, MO,
812-285-2010

MCDANIELS, Pellom, Emory University, 540 Asbury
Circle, Atlanta, GA, 30322, 404-727-6276,
pellom.mcdaniels.iii@emory.edu

MOORE, Christian, The WhyTry Program, 5455 River
Run Drive, Provo, UT, 84604, 866-949-8791,
valerie@whytry.org

N

NEAL, Bianca, ReRoute Productions, PO Box 143595,
Austin, TX, 78714, 5123004376, bianca@saulpaul.com

NEW, Beryl, Highland Park High School, 2424 SE
California Ave., Topeka, KS, 66605, 785-274-6018,
bnew@topeka.k12.ks.us

O

O'BRIEN, Deborah, NoDropouts, 175 S Main Street, Ste
1130, Salt Lake City, UT, 84111, 801-462-2077

O'CUMMINGS, Mindee, American Institutes for Research,
1000 Thomas Jefferson St, NW, Washington, DC,
20007, 202-403-5254, mocummings@air.org

OLIVER, Bernard, University of Florida, 1215 Norman
Hall, College of Education, University of Florida,
Gainesville, FL, 32611, 352-273-4358,
beoliver@coe.ufl.edu

P

PATE, Tammie, Hamline University, Center for Excellence
in Urban Teaching, 1536 Hewitt Ave, St Paul, MN,
55306, 651-523-2502, tpate01@hamline.edu

PAULUS, Nancy, MindlPlay, 2125 Hawks Landing
Drive, St. Louis, MO, 314-229-4493,
njpaulus@educationalproductsgroup.com

PAULEY, Joseph, Process Communications, Inc.,
8740 Sleepy Hollow Lane, Potomac, MD, 20854,
301-983-8447, joe@kahlercom.com

PAULEY, Judith, Process Communications, Inc.,
8740 Sleepy Hollow Lane, Potomac, MD, 20854,
301-983-8447, judy@kahlercom.com

PITTMAN, Karen, Forum for Youth Investment, 7064 East-
ern Ave. NW, Washington, DC, 20012, 202-207-3327,
stephanie@ForumFyi.org.

PRATT, Cornelius, Nelson C. Nix Educational Center -
OCSD5, 770 Stilton Road, Orangeburg, SC, 29115,
803-533-6581, cvp48@orangeburg5.k12.sc.us

R

REVENAUGH, Mickey, Connections Learning, 1001 Fleet
St., Fifth Floor, Baltimore, MD, 21202, 917-834-5768,
mrevenaugh@earthlink.net

RICHARDS, Rebekah, NoDropouts, 175 S Main Street,
Ste 1130, Salt Lake City, Utah, 84111, 801-462-2077,
rebekah.richards@nodropouts.com

ROCKWELL, Cassy, Nebraska Children and Families
Foundation, 215 Centennial Mall South, Suite 200 Lin-
coln, NE, 68508, 402-817-2003, crockwell@nebraska-
children.org

S

SAULPAUL, ReRoute Productions, PO Box 143595,
Austin, TX, 78714, 512-229-8681, saulpaul@saulpaul.com

SCHLINGER, Melissa, ScholarCentric, 2406 W. 32nd
Ave, Suite C, Denver, CO, 80211, 312-282-8667,
m.schlinger@scholarcentric.com

SCHNAKENBERG, Jennifer, Meadows Center for
Preventing Educational Risk, 1912 Speedway
D4900, Austin, TX, 78712, 512-475-6560,
jenniferwick@austin.utexas.edu

SEGALA, Laura, Connections Learning, 1001 Fleet St.,
Fifth Floor, Baltimore, NY, 21202, 917-834-5768,
lsegala@connectionseducation.com

SEHLAOU, Salim, Emporia State University, 1200
Commercial Street, Emporia, KS 66801, 620-341-1200

SMITH, Tomica, Palmer-Munroe Teen Center, 1900
Jackson Bluff Road, Tallahassee, FL, 32304,
850-891-2568, Tomica.Smith@talgov.com

STRAIT, Jean, Hamline University, Center for Excellence
in Urban Teaching, 1536 Hewitt Ave., St Paul, MN,
55306, 651-523-2981, jstrait02@hamline.edu

SUMMERS, Tunisha, Nelson C. Nix Educational Center
- OCSD5, 770 Stilton Road, Orangeburg, SC, 29115,
803-533-6581, ttp17@orangeburg5.k12.sc.us

SYNODINOS, Jean, 809 Kavanaugh Drive, Austin, TX,
78748, 512-291-4753, jeansynodinos@yahoo.com

SWANSON, Eric, Watertown High School, 200 9th St.
NE, Watertown, SD, 57201, 605-882-6316,
eric.swanson@k12.sd.us

T

TERRONEZ, Troy, Watertown High School, 200 9th
St. NE, Watertown, SD, 57078, 605-882-6316,
Troy.Terronez@k12.sd.us

THEIS, John, USD 309, 400 N. Nickerson, Nickerson, KS,
67561, 620-664-0621, jtheis@usd309ks.org

THEIS, Deb, USD 309, 23 E. 1st #5, Hutchinson, KS,
67501, 620-899-4696, dtheis@usd309ks.org

THERRIAULT, Susan, AIR, 1000 Thomas Jefferson,
Washington, DC, 20007, 781-373-7007,
stherriault@air.org

THOMPSON, Betsy, The University of Kansas, JR Pearson
Hall - Rm 317, 1122 West Campus Road, Lawrence, KS,
66045, 785-260-1747, betsythompson@ku.edu

THORNTON, Dawna, Connections Learning, 1001 Fleet
St., Fifth Floor, Baltimore, MD, 21202, 917-834-5768,
dthornton@connectionseducation.com

TURNER, Lynn, Florida State University, 935 Poser
Court, Tallahassee, FL, 32317, 850-894-3680,
lbturner@admin.fsu.edu

U

URBANSKI, Jason, Overcoming Obstacles, 125 Maiden
Lane, 5th Floor, New York, NY, 10038, 212-406-7488,
jason@overcomingobstacles.org

W

WELCH, Chris, Sinclair Community College, 444 W. Third
St, Room 12-382, Dayton, OH, 45402, 937-512-5185,
christopher.welch@sinclair.edu

WILLER, Frederic, Highland Park High School, 2424 SE
California Ave., Topeka, KS, 66605, 785-274-6026,
fwiller@topeka.k12.ks.us

WILLIAMS, Gary, The Learning System, 314 W. Brit-
ton Rd., Oklahoma City, MO, 73120, 800-736-3658,
glwill55@att.net

WILLIAMS, Steve, Nelson C. Nix Educational Center -
OCSD5, 770 Stilton Road, Orangeburg, SC, 29115,
803-533-6581, steve.williams@ocsd5.net

DIRECTORY OF EXHIBITORS

ORGANIZATION	DESCRIPTION
<p>Connections Learning - Pearson Pat Salstrand 23023 Turtle Creek Circle Cold Spring, MN 56320 P: (320) 249-9160 psalstrand@connectionseducation.com</p>	<p>Connections Learning—Pearson provides schools K-12 online academic solutions to meet the needs of a diverse student body. Solutions include credit recovery, blended learning, summer school, online speech therapy, and original credit courses.</p>
<p>Hustle University Hotep 4156 Kings Troop Road Stone Mountain, GA 30083 P: (404) 294-7165 hustleuinc@gmail.com</p>	<p>Hustle University’s Make A Way Program provides relevant curriculum materials and staff training that bring results. Learn more at www.MAKE-AWAYNOW.com</p>
<p>Kansas Enrichment Network Marcia Dvorak 1122 W. Campus Rd. JRP Room 320 University of Kansas Lawrence, KS 66045 P: (785) 864-9665 F: (785) 864-7457 mjdvorak@ku.edu</p>	<p>The Kansas Enrichment Network is a statewide resource charged with making connections for expanded learning opportunities—a strategy that keeps youth in school.</p>
<p>Kansas State Department of Education Nicolette Geisler 120 SE 10th Avenue Topeka, KS 66612 P: (785) 368-6207 F: (785) 368-6284 foulkest@missouri.edu</p>	<p>The Kansas Volunteer Commission, Kansas Mentors, and Kansas DropINs will provide information and share resources to assist programs and schools in implementing dropout prevention strategies, including AmeriCorps funding opportunities.</p>
<p>MindPlay Reading/Ascend Math Nancy Paulus 2125 Hawks Landing Drive Lakes St. Louis, MO 63367 P: (314) 229-4493 njpaulus@charter.net</p>	<p>MindPlay Virtual Reading Coach has helped over 6 million struggling readers of all ages. Ascend Math has also met the needs of students who have dropped out and returned to school. Data will be shared!</p>
<p>Missouri AfterSchool Network Terri Foulkes 1110 S. College Ave., Rm. 130 Columbia, MO 65211 P: (573) 884-2462 F: (573) 884-4225 foulkest@missouri.edu</p>	<p>Missouri AfterSchool Network fosters partnerships, influences policy, and builds systems of support for programs and professionals in order to increase the availability and quality of afterschool programs.</p>

DIRECTORY OF EXHIBITORS

ORGANIZATION	DESCRIPTION
<p>National Dropout Prevention Center/Network John Peters 209 Martin Street Clemson, SC 29631 P: (864) 656-0253 F: (864) 656-0136 pj@clemson.edu</p>	<p>Stop by and learn the benefits of membership in the National Dropout Prevention Network. Review the research publications published by the Center regarding at-risk youth. Publications will be available on mentoring, alternative schooling, early childhood development, and service-learning.</p>
<p>ReRoute Productions SaulPaul P. O. Box 143595 Austin, TX 78714 P: (512) 229-8681 saulpaul@saulpaul.com</p>	<p>ReRoute Productions mixes entertainment, education, and technology to create multimedia products to assist educators and youth workers in reaching hard to reach youth.</p>
<p>The Dibble Institute Cathy Guidry P. O. Box 7881 Berkeley, CA 94707-0881 P: (800) 695-7975 F: (510) 649-5009 cathy@dibbleinstitute.org</p>	<p>The Dibble Institute provides research-based, relationship skill-building resources for teens for use in community-based programs, schools, and health organizations.</p>
<p>The Learning System Laura Crump/Don Lee 3140 W. Britton Road, Suite 202 Oklahoma City, OK 73120 P: (405) 848-6888 F: (405) 843-2559 l.crumpett@hotmail.com</p>	<p>The Learning System is a provider of core curriculum assessments and coursewares for credit recovery.</p>
<p>The Master Teacher, Inc. DeAnn Spade P. O. Box 1207 Manhattan, KS 66505-1207 P: (800) 669-9633 F: (800) 669-1132 orders@masterteacher.com www.masterteacher.com</p>	<p>We provide resources that are dedicated to helping you develop your staff, support their continued learning, and honor their efforts to grow personally and professionally.</p>



National
Dropout
Prevention
Network

25th
Annual
Conference

Pathways to the **PROMISE**

2013 National Dropout Prevention Network Conference

Career

Technical

University

Military

Conference Strands:

Literacy
School Climate
Data Assessment
Curriculum and Instruction
College and Career Pathways
Leadership, Policy, and Governance
Student Support Services and Interventions
Student, Family, and Community Engagement

Presented By:

The National Dropout Prevention Network
Georgia Department of Education
Georgia Regional Educational Service Agencies (RESAs)
Communities In Schools of Georgia

November 3-6, 2013
Crowne Plaza Ravinia
Atlanta, Georgia

For more information visit www.dropoutprevention.org

The InterContinental Kansas City at the Plaza

PAVILION LEVEL

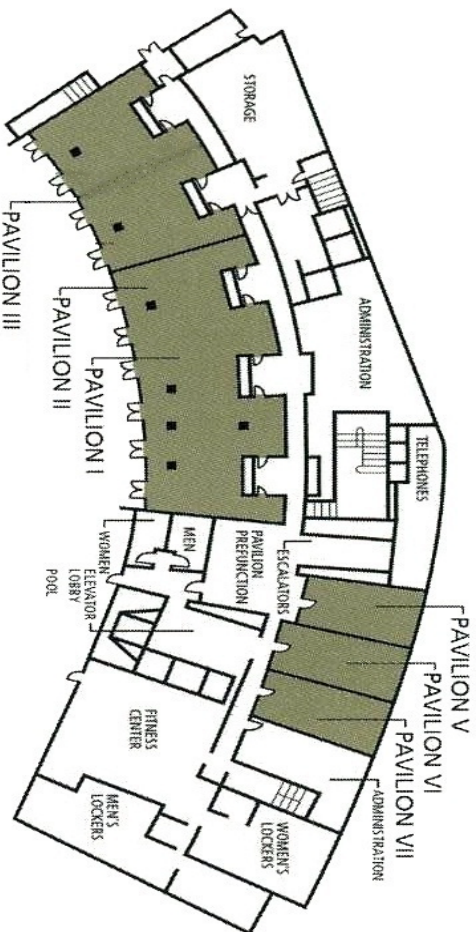

BALLROOM LEVEL

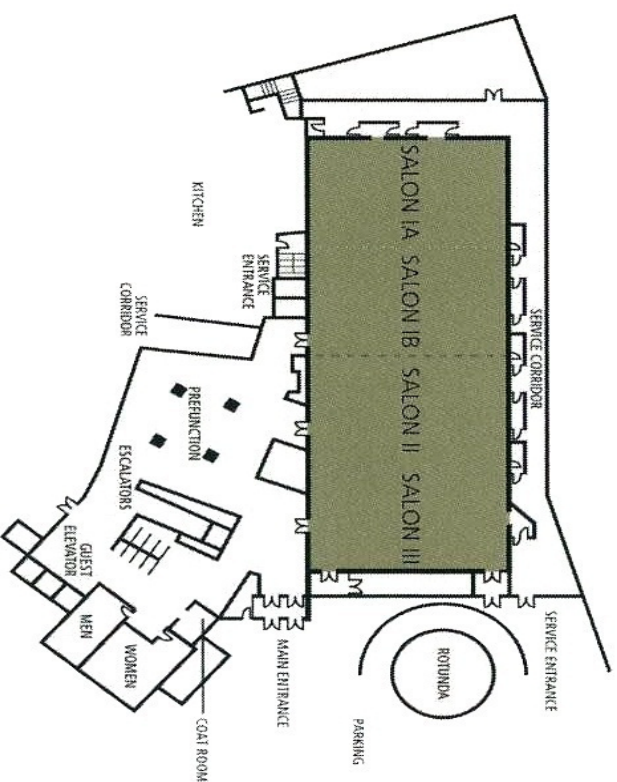

CONFERENCE LEVEL

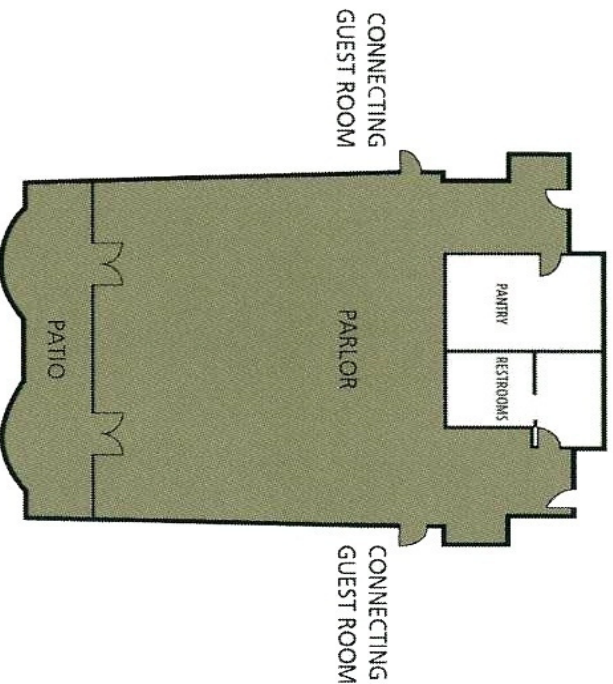

To the Pavilion Level:

From the Ballroom Level please take either the escalator located in the Ballroom foyer up one level to the Pavilion Level or the Bank of Elevators located in the Ballroom Foyer up one level by pressing "P" on the Elevator. The Pavilion Level is one level above the Ballroom Level.

To the Conference Suites:

Conference Suites may be reached by taking the Bank of Elevators located in the Ballroom Foyer to the appropriate floor for the conference suite. For example, for Conference Suite 241, you will take the elevator to the second floor and follow the signs on the floor that direct to Conference Suite 241. Conference Suite 341 would be located on the 3rd floor. Each Conference Suite will look like a guestroom from the outside as they are located on guestroom floors.

The National Dropout Prevention Center and Network

A National Authority Ready to Meet Your Needs in Dropout Prevention Solutions

Our Mission

The mission of the National Dropout Prevention Center/ Network is to increase graduation rates through research and evidenced-based solutions. We believe that graduation is linked not only to educational attainment, but is vital to job success, financial security, and quality of life. Across our twenty-six year history, our organization has promoted high academic achievement and engagement for all students and continues to be uniquely positioned through our Network and our Center to both engage in deep research AND to translate that research into evidence-based solutions that we tailor and implement for our customers.



Our Work

Our team of researchers and practitioners supports a myriad of clients including state departments of education, state and community agencies, higher education institutions, and individual schools and districts.

- **The research arm of our organization continues to convene research teams across the country to conduct research related to dropout issues and solutions as well as to function as a clearinghouse for dissemination of those findings**
- **Our staff is available to respond to requests for customized support and services including**
 - **Comprehensive third-party program evaluations and follow-up strategy implementation**
 - **Professional learning, presentations, and events**
 - **Proposal development**
- **Our staff seeks opportunities to partner with other agencies and organizations to collaboratively tailor services and pursue funding opportunities aligned with our mission.**
- **We sponsor national and regional conferences to help others learn new solutions to the dropout crisis**
- **Our Web site (dropoutprevention.org) and publications provide outstanding resources including statistics, model programs, online professional learning, and guidebooks on the research-based strategies**



Contact Us Today

Let us leverage our 26 years of research, evaluation, professional learning, and customized outreach experience to tailor solutions to make the difference in your organization